



BERRY TOWN CRIER

PO BOX 202 BERRY NSW 2535

WWW.BERRYALLIANCE.ORG.AU

 WWW.FACEBOOK.COM/BERRYTOWNCRIER

MARCH 2023 PRICE: \$5.00

GARDEN CLUB AND PLANT PROPAGATION'S PLANT SALES

Page 24

COMPUTERS FOR SENIORS IS BACK FOR 2023

Page 19

FIND OUT ABOUT VOLUNTEERING FOR ROTARY CLUB

Page 8

OPENFIELD IS SHAPING UP FOR A NEW CONTEMPORARY ART'S FESTIVAL THIS JUNE

Page 23

EVENTS SCHEDULE FOR BERRY RIDING CLUB

Page 19

PARENTING TEENS: SOCIAL MEDIA FORUM ON 10TH MARCH 7PM

Page 10



BERRY ALLIANCE INFORMATION



The Town Crier is produced by the Berry Alliance Inc.

The purpose of the publication is to communicate to the people of Berry about community activities and aims to share information amongst community groups, individuals and the community. A community that is well informed with a range of different opinions makes better decisions and that makes for an even better community that we can continue to be proud of.

Contributions are from the Berry Community who have news and information for our readers.

The opinions expressed in the Town Crier are not necessarily those of the Berry Alliance or of the Editors.

MEMBERSHIP

Membership of the Berry Alliance costs \$15 per annum and is open to Berry community groups registered with the Berry Alliance as well as individuals. To join please write to Berry Alliance, PO Box 202 Berry NSW 2535 or email: info@berryalliance.org.au

Editor's Note



The closing date for our April issue will be Wednesday 15th March 2023 at 5pm. Please submit prior to this date if it is your first submission. Material can be submitted via e-mail to:

towncrier@berryalliance.org.au

Phone 0428 037 572

Town Criers can be downloaded for free from www.berryalliance.org.au or our Facebook Page: Berry Town Crier.

Nancy Davies - Berry Town Crier

THE TOWN CRIER IS PUBLISHED MONTHLY, WITH A CIRCULATION OF 2,400 COPIES AS WELL AS ELECTRONICALLY BY EMAIL OR ON OUR WEB SITE

PRINTED BY **Berry Printers**
CONCORDE WAY BOMADERRY PH: 4422 3774

PRINTED ON RECYCLED PAPER



No Decision yet on the application for modifications to the existing development consent for a new service station at 75-79 Queen St. Berry

This application has raised a number of concerns in our community.

There are people who are in favour of some aspects of the application – including but not only :

the service station includes a shop;
the shop would operate 24 hour a day, 7 days a week.

And there are people with major concerns - including but not only:

Shop operating 24 hours a day and 7 days a week;

the shop is proposed to be moved to the street front;

the proposed 9 metre high sign;

the general character of the design not being appropriate in Berry.

In fact there is a petition against the proposal and of course there is the

opportunity for anyone in the community to make a submission on the Application through Council DA Tracking system.

The application has yet to be determined (as at the 15th February).

Council will usually accept submissions until their final decision, and that final decision has not yet been made.

You can still make your submission by going to: <https://www.shoalhaven.nsw.gov.au/Home>

choose DA Tracking; and enter DS22/1239 this will take a little time to load as there are a large number of documents and submissions.

Berry Town Crier



ADVERTISEMENT

On Your Side.

I am your representative in the Australian Parliament. I can help with issues like Medicare, Centrelink, aged care and pensions, the NDIS, Veterans' Affairs and community grants.

I can also arrange special birthday and anniversary messages, and information for pensioners and seniors.

You can contact me on 4423 1782.

Fiona Phillips

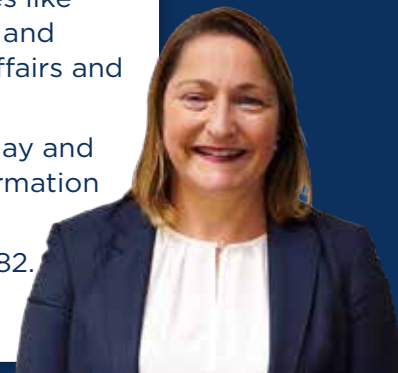

FIONA PHILLIPS MP

FEDERAL MEMBER FOR GILMORE

☎ (02) 4423 1782

★ 3/59 Junction Street Nowra NSW 2541

★ 1/6-8 Orient Street Batemans Bay NSW 2536

✉ Fiona.Phillips.MP@aph.gov.au

📧 Fiona Phillips MP 📧 @fiboydphillips

🌐 FIONAPHILLIPS.COM.AU

Authorised by Fiona Phillips, ALP, 3/59 Junction Street Nowra

Huntingdale Park Resident Action Group update

SF109665 – Proposed New Torrens Title Lots on Hitchcocks Lane Berry. This is for over 300 housing lots.

Urgent Action is Now Called For
Please make a submission on this – see details below.

Our group has made detailed submissions and representations on the current application **SF109665 – Proposed New Torrens Title Lots on Hitchcocks Lane Berry.** This is for over 300 housing lots.

Issues pertaining to traffic (including traffic studies and assumptions made in some of these); Landscaping and trees – removal and retention; confusing and contradictory maps in the application; lack of clarity on a number of issues including Council's request for a number of changes.

Council responded to our joint submission resulting in Council writing to the applicant requiring and requesting a large number of further or updated reports and considerations. The response was disappointing in a number of ways and we are taking those issues up with Council as we reported previously.

One of the main issues was that our joint submission only formally counts for 1 submission and this can sometimes be confused by Councillors and staff.

Consequently, we are now calling for individuals and households to make a submission. (see below)

Council's letter to the applicant was sent to them on 18-1-2023 and to date Council have received no written response apart from an email on 14-2-2023 requesting a meeting with Council staff.

The issues raised in Council's letter to the applicant go to the overall impact of this development, in particular traffic, noise, aesthetics and more sensible design issues as well as some formal errors requiring

amending, updated reports (traffic for example) and assumptions made in the application:

A quote from that letter from Council :
"...Council has recently requested the applicant review these and respond to the issues raised. A response will be provided as soon as possible, with relevant points to be considered under planning grounds"

"... in the event of significant amendments being made to the application prior to determination, this would require formal re-notification of the application in accordance with Council's Policy. However, re-notification is not required in the circumstance an amendment may have a lesser or same affect."

"...I note that this application has been called up by the Council for decision due to public interest"

Our group continue to pursue an improved application and result on this for our community.

If you live in the Huntingdale Park Estate area and would like to join our group please email rick.bmfberry@bigpond.com or post to PO Box 325 Berry 2535 with your name, address, telephone number and email and we can put you on our list.

ACTION PLEASE:

We are requesting our members and Berry community members who have concerns with this development application to make a submission urgently;

You can view the documents on Councils DA Tracking system

Go to: www.shoalhaven.nsw.gov.au

* click on **DA Tracking**,

* you will need to accept their conditions then **select / type in SF10965.**

* when it comes up press **SELECT**

* it will then take you to that Application,

click **Show** (there are many details here and consequently takes a little time to open. Please be patient.)

* now run down the list of **documents** on the second half of the page and select each by clicking **"view"** it will appear on your screen offering to open it and warning some are large files.

You can make a submission here as well by clicking: "Contact us about this application" right at the bottom of the list of correspondence / submissionS. It can be as simple as saying something like:

I have serious concerns on the layout of this development and in particular the use of Hitchcocks Lane as one of the major access points to the development. This would result in a large increase in traffic on our local roads along with increased noise and inconvenience both during the development stage (excavators, road builders, water and waste water as well as all the other services to go in even before the house building stag. This traffic and noise issue would then continue when the houses are finished and occupied.

I submit that Council should require the applicants to:

use Schofields Lane as the main access point or one of the main access points

remove the access from Hitchcocks Lane
Insist (make it conditional) that the works be staged and that the main access point off Huntingdale Park Road (at the first roundabout) be built first and then be used exclusively for all work on the site. (along with Schofields Lane if this is achievable.

Request that Council hold a resident's briefing on the development at the earliest possible date.

NOW OPEN

We also cater for cats!

Bring your Dog!

THE FLYING DOG & CO
PET BOUTIQUE || BARKERY

STYLISH PET ACCESSORIES
GOURMET DOG TREATS
BEDS / BOWLS / TRAVEL & GROOMING ACCESSORIES
VARIETY OF DOG LOVER MERCH AND HOMEWARES
PLUS MORE!

Now Baking Onsite

Shop 6 - Cnr Queen / Alexandra St, Berry

HERITAGE.101
FIND OUT ALL YOU EVER NEEDED TO KNOW,
BUT WERE TOO BUSY TO ASK

Berry Uniting Church Hall
71-77 Albert St, Berry

Wednesday 29 March 2023
9am to 3pm

Fee \$10 per person
Including Morning Tea
BYO Lunch

Bookings:
Trybooking Heritage 101
Opening 1/2/23

Brought to you by:
Heritage Solutions &
Berry and District
Historical Society

Slow Food®

Berry to JB

Slow Food Berry to JB is a local organisation that promotes Good Clean and Fair Food for everyone. It has monthly events for its members which range from long lazy chatty lunches at local restaurants to meetings more of an informal informative nature which address important issues to all who are interested in sustainable food and drink production.

December was a busy month with

- The award of the 2023 SlowFood Snail of Approvals being decided. These awards are made to local businesses in the Berry to Jervis Bay area for their active promotion of Good Clean Food for Everyone. There were 21 in total with several in Berry including Garnish Creative Catering, Flavours, Pickled Ink Kitchen, South on Albany, The Garden, and Berry Farmers Market.
- The Christmas Party and the Celebration of Terra Madre being held at Merro Springs. Over 60 members and friends attended with splendid food provided by the SlowFood team of chefs. The opportunity was taken to award the Snail of Approval to six of the awardees present.

UPCOMING EVENTS • Wednesday 15th February 2023 – there will be a picnic by the sea at Greenfield Beach starting at 1130. • **Saturday 25th March 2023** – a morning event to learn about soil and how important it is in growing the best vegetables and plants. Kirsty Hambrook of Terrewah Farm in Kangaroo Valley will be helping us understand the biology of soil, how to test it and get the right balance of nutrients.

Slow Food welcomes non-members to most of its events albeit at an increased entrance fee.

For further details of all events visit the website www.slowfoodberry2jb.com.au.

All bookings can be made through Trybooking.com - Slow Food membership continues to grow. If you would like more information please email info@slowfoodberry2jb.com.au or visit www.slowfoodberry2jb.com.au

The Berry Forum

www.berryforum.org.au

ROADWORKS STATUS

Council received a status update on 13 February, and we've requested a presentation for the next Forum meeting.

Wattamolla Road There is a total of nine moderate to major landslips requiring repair along Wattamolla Rd as result of the 2022 severe weather events. Two landslips are classified as major and are included in the Major Landslip repair package to commence March 2023. Locations are rural addresses 13 and 356. A further six landslips are classified as "moderate" and are included in a separate landslip repair work package still being developed. Locations are rural addresses 310, 366, 388, 396, 404 and 405.

Crozier Rd Bridge, Jaspers Brush Following completion of investigation and design work and the calling of quotations, repair work to Crozier Rd bridge has commenced and will take four weeks to complete. Work involves the construction of a rock / concrete retaining wall to stabilise creek bank against erosion that had already started to undermine the bridge.

Upcoming Pavement Rehabilitation

Work being scoped. Request for Tender to be issued March 2023.

- Valley Rd, Berry Mountain
- Hillandale Rd, Broughton Vale
- Agars Lane

Tree Management - 45 Degree Rule Amendment

Council is proposing to trial changes to the current 45 Degree Rule Exemption for tree removal in the Shoalhaven Development Control Plan for a period of 12 months. The 45 Degree Rule Exemption has been in place since 2004 and allows the removal of trees in urban areas (not Rural zones) without Council consent, subject to certain criteria.

- The proposal includes refinement of terminology and some additional criteria, including:
 - The tree must pose a demonstrable (actual) risk to the building.
 - The tree must be located on the same lot that the building is located on.
 - The tree must not include a hollow and/or nests (for example, stick bird nests), or be on an upward slope greater than 18 degrees from the building.
 - The tree must be removed by an Australian Qualifications Framework (AQF) Level 3 arborist in accordance with the relevant Australian Standards
 - The landowner is to notify all adjoining and adjacent landowners/occupants and Council of the proposed tree removal in writing, at least 5 business days before the tree removal is due to commence. The notification to Council must be signed by the arborist removing the tree/s.
- The 45 Degree Rule Exemption is not being completely removed from Council's Development Control Plan. The proposed changes do not alter a landowner's ability to remove a tree that is a genuine imminent risk to human life and/or substantial property.

Next Forum Meeting: The next meeting date has been changed to Thursday 2 March 7.30pm at the Uniting Church Hall.

Berry Medical Centre welcomes Dr Irina Jovanovic

Irina completed her medical degree in the Netherlands in 2013 and has gained invaluable experience in Emergency Medicine for several years before switching to General Practice. She is very passionate about travelling and exploring new cultures, always striving for a balanced life with surfing, yoga and meditation as her main hobbies.

Over the past years, Irina has developed an increasing interest in holistic patient care, focusing on prevention of disease and acknowledging the importance of a healthy mind-body axis. Specific areas of medicine Irina enjoys are Paediatrics (children), Women's Health and antenatal (pregnancy) care.

Irina has appointments available on a Tuesday, Wednesday and Thursday.



Appointments can be made online through our website www.berrymedicalcentre.com.au or by using the HotDoc App

KATELIN MCINERNEY

/A FRESH START FOR BERRY

SCAN HERE



FOR MORE INFO ON ALL
OUR UPDATED POLICIES



WWW.FRESHSTARTPLAN.COM.AU



KATELINMCINERNEYKIAMA



KATELIN.MCINERNEY@NSWLABOR.ORG.AU

Authorised by Bob Nanva, Australian Labor Party (NSW Branch), Level 9 377 Sussex Street, Sydney NSW 2000



ON SATURDAY, 25TH MARCH,

*We're supporting
Gareth Ward because...*

SCAN ME



"Gareth has secured grants and supported upgrades for our Broughton Vale-Berry Rural Fire Brigade Station. He is a strong supporter of the NSW RFS and volunteers across our region."

David Southam
Local Berry Resident



"Gareth gets things done. He delivered the Berry Bypass, funding for Boongaree and upgrades and additional staff at Berry Ambulance Station."

Heather Fealy
Local Berry Resident



"Gareth helped secure funding to install a new digital scoreboard at the Berry Magpies home ground and also funding to upgrade the Berry Sporting Fields."

Joe Rogers
Local Berry Resident



"Gareth has strongly supported the Berry Show, works hard and gets results as our local MP."

Molly Fishpool,
Berry Show Young Woman of the Year
2021-2022



About Dr Tonia Gray

"Having lived within the Kiama electorate for over 30 years, I understand the pressures facing local people.

As a Berry resident and your local councillor I'm standing for the Greens because our local communities are demanding more transparent and honest decision making from our politicians.

The current government has done next to nothing to address housing affordability, emergency accommodation and the climate crisis. It's policies have widened the gap between the rich and poor.

As a university professor with higher degrees in education and health, I am acutely aware that NSW's workforce is beyond breaking point.

There's not enough teachers, nurses or paramedics despite the government's own reports warning of critical workforce shortages for years.

Vote Green if you want to:

- Return planning powers to local communities.
- Turbo charge action on climate change to reduce sea level rise and coastal erosion and to future proof our power needs by increasing renewable energy.
- Strengthen free access to health, education and transport services.
- Listen to and walk with First Nations people towards justice and reconciliation.
- End the special treatment given to property developers, gambling profiteers and gas and coal corporations.
- Protect the natural environment and agricultural lands from excessive and inappropriate over-development

Vote Green for a Fairer, Healthier and Cleaner Future

Vote 1 for the Greens team to put us into the Upper House balance of power.



Lynda-June
Coe

Cate
Faehrmann

Dr Amanda
Cohn

We have the answers to the difficult questions facing our community.



Use the QR code to read our detailed policies, donate or get involved in the campaign . Otherwise visit our website:

<https://kiama2023.kiamagreens.org.au>

Contact Tonia and the Campaign



Tonia Gray for Kiama



Tonia_gray



02 4428 1550



Tonialgray



kiama.state@nsw.greens.org.au



You're Invited!

Come, find out the benefits of what being a member of Rotary provides you.

An Information Night is being held for those interested in finding out about joining the Rotary Club of Berry - Wednesday 22 March 2023 at 7pm.

Through Rotary's service programs, a Rotary Club can have a significant effect on the quality of life in its community, and with international partnerships help people in need worldwide.

Some 1.4 million Rotarians in 30,000 clubs in more than 160 countries make significant contributions to the quality of life at home and around the globe.

Rotary's rich history and the organisation's mission and structure have all worked to promote literacy, provide disaster relief, support Rotary's global effort to eradicate polio, and address other critical community, environmental and world issues.

Membership in a Rotary club offers several benefits including:

- Effecting change within the community.
- Developing leadership skills.
- Gaining an understanding of, and having an impact on international humanitarian issues.
- Developing relationships with community and business leaders.
- Forming lasting friendships.

To find out more and to register your interest in attending this Information Night please email berryrotary@gmail.com or contact President Haseena Twedde on 0409 318 171



Berry - once a private town

Prior to colonisation Berry was home to the Dharawal speaking people of the Yuin nation. Broughton Creek, as Berry was known until 1889, began in 1825 as a private town, part of Alexander Berry's and Edward Wollstonecraft's Coolangatta Estate. In 1873, on Alexander's death, the estate passed to his brother, David Berry.

The first settlement was on the river flats between the hill where David Berry Hospital stands, the old Princes Highway and Pulman Street. All early settlers were on ground leased from Alexander.

The people of Broughton Creek began to feel that the hill site was unsuitable for development due to flooding. So, in 1883, they asked David for suitable level ground for a new town site. David had a plan drawn up for a town also known as "Broughton Creek", virtually as Berry is today. Most businesses were situated along Prince Alfred Street, the main thoroughfare to a wharf beside the Coolangatta Road bridge. 10 acres was allocated for the Showground. The town's name was officially changed to "Berry" by the *Berry Municipal District Naming Act 1890*.

On David's death in 1889 (unmarried and childless) the Berry Estate, valued at £1,250,000, comprised 500 acres at North Sydney, 80,000 acres north and south of the

Shoalhaven River from Gerringong to Jervis Bay, and an estate described as "a tract of swamp and jungle".

The Coolangatta lands were left to his cousin, Sir John Hay, and remaining lands were sold to finance David's generous bequest of £100,000 to St Andrews University, Scotland for the Berry Chair of English Literature (still functioning today), £100,000 for the David Berry Hospital for non-infectious diseases and £30,000 for the Presbyterian Church.

An auction for practically the whole of the Berry township was conducted on market day on Wednesday, 21 February 1912. A large enthusiastic crowd came from miles around to the Showground grandstand. The local Council acquired the Showground, the churches bought lands

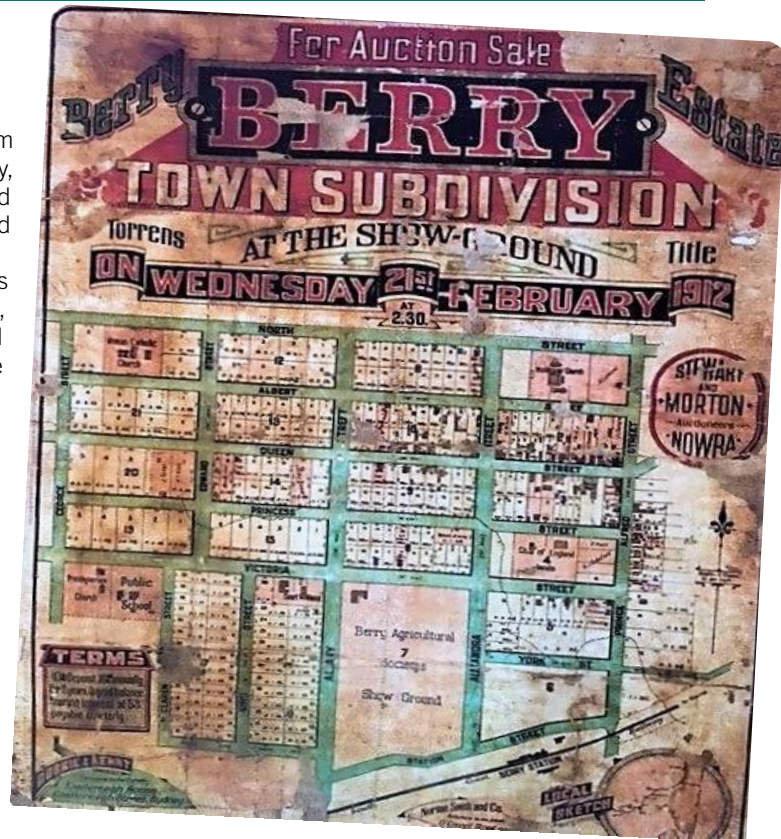

on which they were operating, and many tenants purchased their cottages, for such sums as £110 to £280. Berry was a private town no longer.

Berry Museum

135 QUEEN STREET BERRY



OPEN HOURS: Saturdays, Sundays, School Holidays
and Public Holidays 11.00am-3.00pm

FREE ENTRY

www.berryhistory.org.au

If you'd like to join us, please call in to the Museum and have a chat, call (4464 3097)
or email us berrymuseum@bigpond.com - We look forward to meeting you.

PINK UP BERRY

PROUDLY SPONSORED BY
THE BERRY ALLIANCE AND
BERRY TOWN CRIER



Pink Up Berry is delighted to once again be pinking up the town and raising funds for the McGrath Foundation in October 2023.

The McGrath Foundation do an amazing job by providing specialised Breast Care Nurses to support those that are experiencing Breast Cancer and their families- it is their hope to have 250 nurses all over Australia by 2025 so no one misses out on this support which is provided free of charge.

Thank you once again to everyone that supported Pink Up Berry in 2022 and the amount raised was \$47000- this could

not have been possible without so many supporting us in so many ways.

The committee members for 2023 are: Deb Woolford, Sandy Bramley, Pauline Windley, Kerry Cater-Karen Brooks and Taleen Smith- please feel free to contact any committee member if you would like more information or would like to join our volunteers group.

The Berry Barnlet kindly stock homemade Condiments & Jams that are sold for Pink Up Berry all year round so pop in & stock up on some goodies- The Barnlet is open Thursday to Sunday.

Our hope this year is to have more trees decorated with crocheted Mandalas that

looked amazing- and attracted lots of visitors taking photos in front of them - so if you would like to make some - call into the girls at the Berry Barn that can give you instructions on how to crochet them.

We are always wanting small to medium size screw top jars so if you would like to collect some you can drop them off to Debs verandah at 34 George Street Berry.

**FOR ANY ENQUIRES YOU CAN EMAIL US
PINKUPBERRY@GMAIL.COM OR
PHONE 0428 005 910.**



TOGETHER WE CAN MAKE A DIFFERENCE!



Parenting Teens:

Social Media Forum on 10th March 7pm

Is it just me, or is parenting becoming more and more complex? Social media, mental health issues, peer pressure, and impacts of the lockdown – today's teens are coping with a lot.

So are their parents! We're living in a time of rapid change. When I was a teenager there were no phones, the internet was just starting and took all of school lunch time to load up (accompanied by the sound of dial-up), and no one knew what anyone was doing once they left school for the day. We got to turn off. In this era of social media, it's hard to switch off at all.

My kids now follow tik tok influencers who I don't know, whose worldview is foreign to me, and who are producing content that is of questionable value. Sometimes, I feel really out of control and like I'm losing connection with the people who matter to me most.

No one has parented in a world this complex before. As parents of this generation, we're all newbies. We need to be kind to ourselves and look for ways to connect and support each other.

With this in mind, South Coast Life Church is hosting a Social Media Forum on Friday 10th March at 7pm. This event is for parents of teens and will be held at 8 Schofields Lane, Berry. Rather, than having an expert come and tell us what we should be doing



with our kids, and what the latest security risk to each new app is, (the police do an excellent job of this: [police.nsw.gov.au/safety_and_prevention/crime_prevention/online_safety/](https://www.police.nsw.gov.au/safety_and_prevention/crime_prevention/online_safety/)), this is a chance for parents to meet over coffee and dessert and share about the struggles, and the joys of parenting teenagers.

We don't have all the answers, but we do want to explore different approaches and learn from each other. If you're interested, you can just turn up, or contact Kate & Gordon Weakley (who are raising four children of their own) on 0403 915 728. Alternatively, visit southcoastlife.org/events.

Berry Youth will be running as usual that evening for youth in Yrs 7-12, and child minding for younger children will also be available.

Erica Noonan
South Coast Life Church
Ph: 0402 699 732

Berry Community Library

Some of the great titles that have been donated to the Community Library include Rain Heron by Robbie Arnott, Still Life by Sarah Winman and Intimacies by Katie Kitamura. Also new David Baldacci and Lee Child books. So little time and so many books to read!



Our next Coffee and Friends will take place on Wednesday March 22nd. We are very excited to have as our speaker a very busy local, Sophie Ray. Sophie and husband Raj are the owners of Silos Estate Winery. Apart from being a business owner, Sophie is a Corporate Lawyer, Non-Executive Director and Chair of the Shoalhaven Education Fund. Sophie will talk to us about her busy life and how her passion for the community has taken her in so many interesting directions.

Everyone is welcome on Wednesday 22nd March at 10am in the Uniting Church Hall.

Library Opening Hours

Monday and Wednesday 1-4pm
Tuesday Thursday and Friday 10-1pm
77 Albert Street, opposite the IGA carpark, behind the Uniting Church.
For more information contact Janet on 0425 220 258

FIND US ON
FACEBOOK



Bringing **life through Jesus** to the south coast and beyond

8 Schofields Lane, Berry

Sunday Services

10am & 5pm

Everyone is welcome!

hello@southcoastlife.org 4464 2315
southcoastlife.org



71-77 Albert Street Berry

Come and join us

Sundays at 9.30

in person or on Zoom

for joining details

email berryuniting@gmail.com

Minister: Rev Andrew Watts

0400 059 191

www.berryuniting.org



Berry Community Preschool

Berry Community Preschool is looking forward to another exciting year! The staff would like to welcome back our children from last year, and we also welcome our new families and look forward to getting to know them over the coming weeks.

The first few weeks of Preschool have been focused on settling the children in as they explore the environment and get to know each other and the Educators. We've had a great start to the year. There's lots to explore and discover indoors and outdoors.

We are sending our best wishes to all our children who have started school this year. We wish them a wonderful start in their next learning journey. We ended last year with a great family Christmas party and were very grateful that once again the Berry Town Fire Brigade visited our party with a very special person, Santa. The children were so excited, and it was such a joy to see how happy they were. Thank you to the Fire Brigade for always helping us out.

We have a few thank yous from the end of last year. We were very grateful to receive a \$500 donation from Ray White Berry. We were also thrilled to receive a generous donation of a \$100 book gift voucher to buy new books for the Preschool, in appreciation for participating in Berry Masonic Village's annual Christmas card design competition. Berry Community Preschool is a community owned and run, not for profit Preschool educating children three to five years of age with an Exceeding the National Quality Standard rating by ACEQCA. We are very grateful for the support from our wonderful community. We are looking forward to a fun-filled year with lots of learning and lifelong friendships forming.



SUPREME MASTER TV
Constructive Programming for a Peaceful World

SupremeMasterTV.com

Broadcasting Wonderful News and Positive, Encouraging Programs 24 Hours a Day

Sharing Messages of Love and Peace That Create Positive Energy for a Better, Shining World

QR code

SCOOTERS WHOLESALE
WE COME TO YOU

2/21 Quinns Lane, Sth Nowra

LIKE US ON FB: **facebook**
Scooters Wholesale Nowra

Mobility Aids
Lift Chairs
& More

PH **4422 8438**
scooterswholesale.com.au
Servicing the Berry District Since 1992

Featured Listings.

106 North Street, Berry



With escarpment views, close proximity to town and Boongaree Nature Park, this large property delivers on location. With four bedrooms, renovated kitchen, 2 bathrooms and a sprawling back yard, 106 North Street awaits its next owner.

Contact Jane Zwar on 0401 174 856.

155 Carrington Rd, Beaumont



If you are not familiar with the suburb of Beaumont, you are in for a treat. Beaumont is nestled between Berry, Kangaroo Valley and Cambewarra Village and home to this stunning property. Enjoy sweeping views of the region on 15 acres of picturesque land. With a main homestead plus 3 cottages, there is much to see.

Contact Nick Dale on 0419 425 166

41 Shackleton St, Shoalhaven Heads



This beautifully renovated, coastal property is located next to the beach walking track at Shoalhaven Heads delivering a relaxed beach lifestyle. With 3 bedrooms, open plan living, a pool and lots of storage, this property is a must see.

Contact Jane Zwar on 0401 174 856.



Market Insights.

From Nick Dale.

There is no denying we are currently trading in a challenging market. Vendors are being asked to show considerable patience as buyers are influenced by the media and interest rate rises. However there is a narrative I don't believe is being told that tells a much more positive picture of the current real estate market.

I recently read an article by Michael Yardney, that also reflects my optimistic beliefs. Three points I would like to share with you include:

- 1. Interest Rate Reality** - Interest rates are likely to only end minimally higher than what they were prior to the pandemic and the media wasn't reporting mortgage stress back then.
- 2. Savings are High.** Many Aussie's have built up a considerable war chest of savings in their offset account with more than half of mortgage holders having paid their mortgage many months in advance.
- 3. No one wants it to fail.** The Australian residential real estate market is too big to fail and it isn't in the interest of the banks to allow property values to drop.

I encourage both vendors and buyers to look at the big picture optimistically and recognise that seizing real estate opportunities is always a smart move. If you would like to discuss the market or your needs further, please don't hesitate to call me on 0419 425 166.



For more Belle Property news & updates, get a copy of our latest Coast & Valley Magazine. Available from the front of Berry IGA.

In 2023, ADFAS Shoalhaven will commence its 33rd year of offering members and visitors interesting lectures covering a range of subjects relating to creative art forms. We will host nine lectures with presenters from The Arts Society (U.K) and Australian lecturers.

The monthly meetings held at the Berry Uniting Church Hall, are a wonderful and informal way to make friends and to get to know others in the community.

Visitors are always welcome.

\$15 Students (up to university)

\$25 Adults

Information on the Society, 2023 Program, membership and lectures can be found at:

www.adfas.org.au/societies/shoalhaven/
or from Richard at richardcwiseman@hotmail.com



ADFAS-shoalhaven

30 MARCH – 7:30PM

Berry Uniting Church Hall
71-77 Alfred Street, Berry

WHISTLER VS. RUSKIN – FLINGING A POT OF PAINT IN THE PUBLIC'S FACE

Lecture by ALAN READ

*Visitors Fee: \$25 Adult, \$15 Students
(up to university)*

The famous trial in 1878 between artist and critic became one of the first great public debates in Britain about modern art. This lecture looks at the issues and personalities involved in this famous court-room drama, how their animosity divided the art world and the extent to which it can be argued that the outcome of the trial ruined both Whistler and Ruskin.

Alan Read holds a master's and first class honours degree in History of Art from Birkbeck College, London. He is a gallery guide at Tate Britain, Tate Modern, National Portrait Gallery and for Frieze Masters and regularly lectures at the NPG, Dulwich Picture Gallery, Plymouth City Art Gallery and other galleries in the UK. He also works as a London Blue Badge Guide and a City of London Guide.

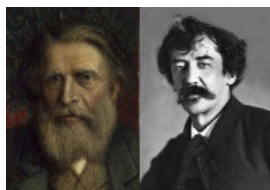

Are you Lost or Unlost?



Have you ever been lost, or lost someone or something? It is a scary thing to be lost. When we lose something, we want to find it right away. This can help us understand how seriously God takes it when a person gets lost in life—for he loves us more deeply than we can imagine.

Jesus knew his mission was to “seek and save the lost” and reunite God’s lost children with God. He has given us that mission too. Jesus told 3 parables (earthly stories with a heavenly meaning); the lost sheep, the lost coin and the lost son. Each story had the ending of something that was lost, was found and there was much rejoicing. Each thing that was lost was so precious to the owner, that they looked and never gave up hope, until they found what was lost. God doesn’t forget any of us and is pursuing every lost person as his beloved child. When they are finally home, the celebration is amazing! Jesus said those without God are his lost children.

Being lost is not a location. It’s a change. It can happen anywhere or anytime throughout our lives. There are times when we are lost from friends, from love, to our families and in ourselves. Times when we are lost in doubt or worry or in grief, anger or hatred. Suddenly we feel dislocated, aimless and wondering.

We ask ourselves or others “*What is God doing in my life? How can I get ‘un-lost’?*”

The world gives us lots of advice to become unlost:

- Stay positive.
- Eat the right foods.
- Get plenty of rest.
- Get good exercise.
- Work hard.

God says:

- Trust me • Talk to me • Ask for help • Let me help

God is working in our lives, doing what he always does—using hard and challenging times, as well as, good and encouraging times to uncover what is really in our hearts. God never changes and is always waiting to give us opportunities to grow and change. He is with us 24/7 and will never leave us alone. Letting God into our lives gives us hope and purpose. When we share God’s love with others, this sends light into the world to save the lost.

Kid’s club is on Friday 10th and 24th March.

Sue Skinner - Berry Presbyterian Church

Surf
ELECTRICAL
KANGAROO VALLEY

CALL BILL OR DEBBIE
0424 867 994 / 0401 759 241

✉ info@surfelectrical.com.au

📘 Like us on Facebook!

Review us on Google ★★★★★

AREAS OF SERVICE:

**BERRY / KANGAROO VALLEY / CAMBEWARRA /
GERROA / GERRINGONG / SOUTHERN HIGHLANDS**

- Fully Insured • Residential • Commercial • Industrial
- 20+ years experience • New Homes • Maintenance
- Renovations & Extensions • Repairs • Upgrades • Installations
- Switchboards • Safety/Maintenance Inspections • Troubleshooting

ABN 70 845 107 241 LIC No. 253095C

neca MEMBER
national electrical and communications association



**Scots' Presbyterian
Church, Berry**

Minister: Rev Isaac Jung

Service Time

Worship Service 10am

Jesus And Me (JAM)

& High School Bible Study 10am

Bible Fellowship Groups

Tuesday 5.30pm • Thurs 10am • Friday 10am

Activities

Kids' Club

Presbyterian Womens' Assoc

Mens' Group

**Ordinary People worshipping
an Extraordinary God**

www.berrypresbyterianchurch.net.au

02 4464 1020

Cnr Alexandra Street & Victoria Street, Berry

Community Groups

BERRY COMMUNITY GROUPS

Berry Alliance Inc. PO Box 202 Berry info@berryalliance.org.au www.facebook.com/berrytowncrier	0449 569 059
Berry Town Crier PO Box 202 Berry towncrier@berryalliance.org.au towncrier@berryalliance.org.au	0428 037 572
Australian Labor Party Berry Shoalhaven Heads Branch PO Box 325 Berry secrearybshalp@gmail.com	4464 2446
Australian Red Cross Berry Branch kate@sonmer.net.au	0418 604 004
Berry Community Library at Berry Uniting Church berrycommunitylibrary@gmail.com	0425 220 258
Berry Courthouse Conservation Committee PO Box 218 Berry 2535 functions@berrycourthouse.org.au www.berrycourthouse.org.au www.facebook.com/berrycourthouse	0458 369266
Berry Masonic Village Auxiliary icbsle@bigpond.com	0411 120 034
Berry Men's Shed berrymensshed@telstra.com	0448 712 131
Berry Probuc Club berryprobuc@gmail.com	4464 1868
Broughton Vale / Berry Rural Fire Brigade broughtonvalerfs@gmail.com	0414 897 227
Country Women's Association Berry Branch 76 Victoria St., Berry berrycwasecretary@gmail.com	0417 423 018
David Berry Hospital Auxiliary ibscile@bigpond.com Irene	0411 120 034
Voice of David Berry Hospital margaret.walsh21@bigpond.com www.voiceofdavidberryhospital.org	0415 887 308
Huntingdale Park Resident Action Group PO Box 325 Berry 2535 rick.bmfberry@bigpond.com	4464 2446
Masonic Lodge Broughton 131 Agricultural Hall, Berry Showgrounds kevinwant@gmail.com	0401 395 401
Red Cross kate@sonmer.net.au	0418 604 004
Rotary Club of Berry berryrotary@gmail.com www.berryrotary.org.au	0409 318 171
St. Vincent de Paul Society Vinnies Shop - 1117B Queen St. Berry	HELPLINE 4421 0390 4464 3940

ARTS

Berry & District Historical Society www.berryhistory.org.au berrymuseum@bigpond.com	0413 893 508
Berry Silver Band Kaye – kayecj@westnet.com.au Meet at Masonic Hall	0490 037 619
Knit With Love St. Lukes Church Hall – 68A Princess St. Berry Lyn Oades – terryandlyn@gmail.com	0404 562 772
OpenField Arts Festival PO Box 5, Berry 2535 www.openfield.org.au info@openfield.org.au	0439 750 029
Red Berry Quilters redberrysec@gmail.com www.facebook.com/redberriesquiltinggroup	0432 603 484

CHURCHES

Berry Uniting Church berryuniting@gmail.com 71 Albert St., Berry	0466 717 254
Scots' Presbyterian Church, Berry Rev. Isaac Jung colin@daydesign.com.au www.berrypresbyterianchurch.net.au	4464 1903
South Coast Life Church erica@southcoastlife.org www.southcoastlife.org Erica Noonan, Lead Pastor F: South Coast Life Church	0402 699 732
St. Luke's Anglican Church 87 Victoria Street Berry www.berryanglican.org office@berryanglican.org	4464 1058
St. Patrick's Catholic Church Berry Fr. Joseph GPO Box 304 Berry www.nowraparish.org.au	4423 1712

EDUCATION AND PLAYGROUPS

Berry Computers for Seniors Uniting Church Hall, 77 Albert St, Berry berrycfs@gmail.com	0414 982 010
Berry Community Pre-School berrypreschool@bigpond.com www.berrypreschool.org.au	4464 1764
Berry Youth Group kateweakley74@gmail.com berry-youth.html	Kate Weakley 0403 915 728 www.southcoastlife.org/
South Coast Kid's Club sharayah@southcoastlife.org www.southcoastlife.org/kids-club	Sharayah Lardner 0407 791 886
South Coast Life Church – Let's Play (Playgroup) Sharayah Lardner sharayah@southcoastlife.org www.southcoastlife.org/lets-play	0407 791 886

GARDENING & LANDSCAPE

Berry Landcare www.landcare.nsw.gov.au/groups/berry-landcare/ www.facebook.com/Southerners2535/	0427 255 417
Berry Public School Plant Propagation berryplantprop@outlook.com https://www.facebook.com/BerryPlantProp Natural Studies and Plant Propagation Centre BPS	4464 3911

RECREATION

Berry Bridge Club Inc. ceciliemlewis@gmail.com www.bridgewebs.com/berry	0417 207 130
---	--------------

SPORT

Berry Men's Bowling Club draym@bigpond.com	4464 2995
Berry Riding Club jasiy@bigpond.net.au www.berryridingclub.com	0410 506 143

Berry Tennis Club PO Box 133 Berry NSW 2535 berrytennis@hotmail.com	
---	--

SPONSORED

A Taste of Paradise admin@atasteofparadise.org.au www.atasteofparadise.org.au	0490 060 251
Berry Community Library 77 Albert St (Berry Uniting Church Hall) berrycommunitylibrary@gmail.com	0425 220 258
Berry Farmers Market Berry Showgrounds, Thu 2pm – 5pm www.berryfarmersmarket.com.au and Facebook	0431 823 078
Bundanon Trust www.bundanon.com.au	4422 2100
Pink Up Berry Raises Money for the McGrath Foundation pinkupberry@gmail.com	0428 005 910
SALT Ministries Supporting those in need 5-19 Birley St. Bomaderry info@salt.org.au or Facebook	4480 5028
Shoalhaven Education Fund chair@sef.org.au www.cef.org.au/shoalhaven	0414 379 059
Shoalhaven Heads Surf Life Saving Club secretary@headssurf.com.au	

Any Berry Community groups who are yet to provide their updated / renewal registrations please email them to info@berryalliance.org.au. If you need another form email us please. We will add groups as their current details are provided to us. Our apologies if this list does not include your group. Please ensure that we have received your renewal.

Berry Alliance and Town Crier Management Committee

EMERGENCY 000

Police Assistance Line (Non-Urgent Police Reports) 131 444
Berry Police 4464 2175
Fire & Rescue NSW 02 4478 4924

Rural Fire Brigade (Broughton Vale) 4464 1522
SES For Emergency Help in Floods & Storms 132 500
Ambulance - always call 000

We would like to recognise and recommend our Printers – Berry Printers.

Berry Printers have been our partners in producing the Berry Town Crier for nearly twenty years now and since we also engaged them to do our graphic design we have enjoyed excellent, seamless and on time production.

They are a local business (which is an important consideration for us) and a family owned and run business.

We certainly recommend them if you need and printing done, from shop signs to business cards and everything in between.

Thank you for your partnership with us.

Berry Printers 4422 3774

Berry Alliance and Town Crier Management Committee



SUSTAINABLE BERRY AUTUMN 2023

BEES: Encouraging bees in your garden encourages biodiversity helps make veggies and fruit trees more productive. The Berry Co-op sells a seed mix of plants that have flowers bees love. You may also consider leaving part of your lawn unmown, to give dandelions a chance to flower. Bees are especially attracted to yellow and blue/purple flowers. If you've got an unwelcome swarm that needs removing call Brian from the Shoalhaven Beekeepers Association on 0408 961 051. You can find more information at their Facebook page or shoalhaven.secretary@beekeepers.asn.au if you're interested in becoming an amateur beekeeper. <https://www.abc.net.au/gardening/how-to/bee-hotel/9440586> has a video tutorial on how to build your own bee motel for Australian native bees.

FROG ID: A citizen science project run by the Australian Museum in Sydney, is studying dead specimens to determine the cause of death. They believe that an amphibian chytrid fungus involved, but the research team want to determine if there are other factors involved. If you find a dead frog in your garden, email calls@frogid.net.au with any details you have on location, and any photographs. If you are able to collect the dead frog, do so wearing protective gloves, and put the frog in a ziplock bag. The body should be put in your freezer. The research team at the Museum will liaise with you to arrange collection. To get involved with the project, download the FrogID app to your phone to record frog calls; the project uses the recording to identify species and the geo-referenced location, with minimal disturbance to frogs and their habitat.

COUNCIL RECYCLING DATES: Yellow bins are emptied this month on 1, 15 and 29. Bins go out the night prior to collection.

USED RAT TESTS AND DISPOSABLE MASKS: Used test kits are considered contaminated medical waste and must be disposed of in landfill, not your yellow recycling bin.

REKINDLE ME: You may have seen Wade Cawley's red electric van around town. Not only does Wade's business take e-waste to be broken down into its component parts, he will also take electrical goods such as small appliances that no longer work. Wade's business helps keep items out of landfill, and recycles materials for reuse in new items. Check rekindleme.net for more information. Ewing Electrical, a small business in Nowra, repairs small appliances; it may be worth checking to see if your item can be repaired rather than getting rid of it. Their number is 4421 8412

TERRACYCLE: This global foundation was established to fight ocean plastics at the source, and works with communities, accepting hard-to-recycle items. Some programs are free; others offer a pre-purchase box for a fixed fee, to be filled with diverse items and returned (free of charge), for separation and recycling. Various, specific programs are run by manufactures that either accept back their packaging, or . Use your own box, fill and return with a prepaid form. Clubs, schools and businesses are welcome to set up a joint account. To find out more visit www.terracycle.com

ELECTRIC CAR CHARGING STATIONS:

- Park Ridge Retreat, Gerringong: 3 Mennekes (Type 2)s
- Berry Bowling Club: NRMA Network CHAdMO DCFC, CCS DCFC
- The Silos Estate, Jaspers Brush: 6 Tesla Superchargers, 2 Tesla Model S / Model Xs, Wall Outlet (3112)
- Woolworths, Bomaderry: 4 Mennekes (Type 2)s
- Mountain Ridge Wines, Coolangatta: 2 Tesla Model S / Model Xs, 2 Mennekes (Type 2)s
- Bangalay Luxury Villas, Shoalhaven Heads: 4 Tesla Model S / Model Xs
- The Haven at Berry: 1 Tesla destination charger
- Dovecote, Gerringong: 2 Porsche Destination chargers, Type 2

RETURN AND EARN: Closest recycling facilities are at Gerringong (at Blackwood Oval), Bomaderry (Bowling Club), and Nowra (Nowra Fair, Stocklands Mall). Some larger op shops accept bottles and cans to generate income for charity.

WEATHER APPS: We have been fortunate so far to have escaped the recent devastation of flooding, and the previous bushfires that affected southern NSW, Useful apps to keep up to date with the weather, flooding and driving conditions: BOM Weather, Floods Near Me NSW, Fires Near Me and Live Traffic NSW.

KEEP UP TO DATE: Visit local.berry.org.au/berrycare/ for updated news, as well as facebook groups Berry Town Crier, Berry Community Facebook Group, and Berry Community Noticeboard.

DON'T FORGET TO
FILL UP YOUR
REUSABLE BAG AT THE



BERRY
FARMERS' MARKET

HELD EVERY THURSDAY,
AT THE COW SHEDS
BERRY SHOWGROUND
2 PM - 5 PM

FRESH LOCAL PRODUCE AVAILABLE,
ENTERTAINMENT FOR ALL THE
FAMILY AND MUCH MORE.



PROUDLY SPONSORED
BY THE
BERRY ALLIANCE
TOWN CRIER

Become a Friend OF THE BERRY TOWN CRIER

BECOME A FRIEND
OF THE BERRY TOWN
CRIER AND RECEIVE:



UPDATES
NEWSLETTERS
BREAKING NEWS
ELECTRONIC COPY OF THE
BERRY TOWN CRIER EACH ISSUE COLOUR EDITION

JUST EMAIL [INFO@BERRYALLIANCE.ORG.AU](mailto:info@berryalliance.org.au) AND GIVE US YOUR:

NAME:

TELEPHONE:

ADDRESS:

EMAIL:

RETURN TO: info@berryalliance.org.au Drop Box in the Berry PO



DEVELOPMENT APPLICATIONS AND DETERMINATIONS

Here is a list of the most recent Shoalhaven City Council Development Applications and Determinations since the list was produced in the Berry Town Crier – December 2022 edition.

The information on how you can see details and follow these applications, make submissions and see the determinations and details of any conditions applied is provided in the Town Crier each month. It is also provided in the “Friends of the Berry Town Crier” Newsletters sent out regularly between editions of the Town Crier.

Go to: <http://www.shoalhaven.nsw.gov.au/masterviewUI/modules/ApplicationMaster/Default.aspx> Development Application Tracking.

DEVELOPMENT APPLICATIONS:

CD23/1003	– 5-1-2023	– Strata Title Subdivision of Dual Occupancy	– 22 Edward St, Berry
CD23/1004	– 5-1-2023	– Strata Title Subdivision of Dual Occupancy	– 20 Edward St, Berry
DA23/1014	– 9-1-2023	– Alterations & Additions	– 117 North St, Berry
DA23/1020	– 10-1-2023	– Dwelling, Studio, Pool & Pool House	– Beach Rd, Berry
DA23/1034	– 12-1-2023	– Demolition of Dwelling & Construction of Single Storey Dwelling & Detached Garage	– 39 Albert St, Berry
DA23/1038	– 13-1-2023	– Secondary Dwelling – Conversion of Book Storage House to Dwelling as part of a Proposed Dual Occupancy	– 11 Thomas Cl, Berry
DA23/1039	– 13-1-2023	– Demolition of Residential Flat Building & Construction of New Specialist Medical Centre & Commercial Building	– 80 Queen St, Berry
DA23/1016	– 10-1-2023	– Construction of Dwelling & Conversion of Existing Dwelling to Tourist & Visitor Accommodation (Tourist Cabin) – B640 Princes Highway, Jaspers Brush	
CD23/1022	– 19-1-2023	– Swimming Pool	– 25 Parker Cres., Berry
DA23/1063	– 20-1-2023	– Construction of a Detached Shed	– 309 Brogers Creek Rd, Brogers Creek
SF10976	– 19-1-2023	– Three Lot Boundary Adjustment	– Old Pioneer Crst (Priv) Broughton Vale
DA23/1070	– 27-1-2023	– Single Storey Secondary Dwelling	– 88C Kangaroo Valley Rd, Berry
DA23/1071	– 27-1-2023	– Temporary Use of Land (Car Park for the Red Hot Summer Festival)	– Wharf Rd, Berry
DA23/1055	– 1-2-2023	– Roof over Existing Deck & Pool	– 34 Clarence St, Berry
DA23/1091	– 6-2-2023	– Remediation Works, Removal of Five Trees & Installation of Fencing	– 34 Station St, Berry
SF10981	– 7-2-2023	– Boundary Adjustment – Subdivision of Lots 1 & 2 DP 1081549	– 268B Beach Rd, Berry
DA23/1067	– 7-2-2023	– Construction of Residential Dwelling	– 110 Tindalls Lane, Broughton

DEVELOPMENT APPLICATIONS DETERMINED:

DA23/1081	– Approved	– 9-1-2023	– Alterations & Additions to Existing Farmstay Accommodation	– 123A Beach Rd, Berry
DA23/1936	– Approved	– 11-1-2023	– Alterations & Additions	– 30 Jaspers Brush Rd, Jaspers Brush
DA22/2057	– Approved	– 19-1-2023	– Dwelling Alterations & Additions	– 120F Kangaroo Valley Rd, Berry
CD23/1055	– Approved	– 30-1-2023	– Roof over Existing Deck & Pool	– 34 Clarence St, Berry
DA22/1833	– Approved	– 31-1-2023	– Dwelling & Swimming Pool	– 7 Tressider Cl, Berry
DA22/1920	– WITHDRAWN	– 30-1-2023	– Demolition of Dwelling, Construction of 2 Storey Dwelling with Ancillary Studio, Guest Accommodation & Garage	
DA22/2119	– Approved	– 7-2-2023	– Construction of Two Storey Dwelling	– 2 Albany St, Berry
DA22/2258	– Approved	– Demolition of Existing & Construction of New Dwelling	– 60 Borrowdale Close, Berry	
DA23/1071	– Approved	– Temporary Use of Land (Car Park for the Red Hot Summer Festival)	– Wharf Rd, Berry	
DA22/2323	– Approved	– Alterations & Additions to Dwelling & Inground Swimming Pool	– 262A Tulloch Rd, (Priv), Broughton Vale	
CD23/1067	– Approved	– Swimming Pool & Deck	– 23 Fahl Lane, (Priv) Jaspers Brush	

More updates (between issues of the Town Crier) can be found in the Friends of the Berry Town Crier in the Newsletters

Subscribe to be a Friend by emailing info@berryalliance.org.au with your name, email address and telephone number with your request “Subscribe to Friends Newsletter”. Friends also receive an “E” version of each Town Crier (most often prior to delivery) plus reminders of Deadlines and extended article on some issues.

Brought to the Berry community by the Berry Alliance and Town Crier Management Committee



BROUGHTON VALE / BERRY RURAL FIRE BRIGADE BUSH FIRE DANGER PERIOD AND FIRE PERMITS

The bush fire danger period commenced on the 1st September 2022.

“Anyone wishing to light a fire during the Bush Fire Danger Period must obtain a free permit in addition to notifying their local fire authority and neighbours 24 hours before lighting up. If a fire does escape, make sure you call Triple Zero (000) immediately so that emergency services can respond and minimise the damage.” Commissioner Rogers said. “Now is the time to update and discuss your bush fire survival plan. Have the conversation with your family about what you will do during a fire – talk about when you’ll leave, where you’ll go, what you’ll take and what you’ll do with animals.”

For details on making a bush fire survival plan visit www.myfireplan.com.au

For information about the Bush Fire Danger Period, go to www.rfs.nsw.gov.au/BFDP

To notify of your intent to burn, use the online burn notification tool at www.rfs.nsw.gov.au/notify



For information about the Bush Fire Danger Period, go to www.rfs.nsw.gov.au/BFDP

International Women's Day Gala Night

Friday 10th March 2023

Shoalhaven Entertainment Centre



ZONTA
CLUB OF
BERRY INC



Final preparations are underway for the much anticipated International Women's Day Gala Event on 10th March 2023, celebrating women's achievements & raising awareness against bias.

The Zonta Club of Berry is working closely with all the Shoalhaven businesses to secure sponsorship for the evening.

We have already experienced an overwhelming and generous response in support for this wonderful event. We thank all the local businesses who have come on board to support the fantastic work of the Zonta Club of Berry.

We have already sold over a staggering 300 tickets out of 430 available for what is shaping up to be a sell-out black tie event. If you are interested in attending you can purchase tickets here: <https://zontaberry.com.au/>

We were inundated with over 180 nominations for the range of award categories that will all be presented on the night with prize money of \$20,000 up for grabs. We look forward to celebrating the achievements of all the wonderful community members who work tirelessly towards making their local community greater.

We are thrilled to announce Jillian Broadbent as the keynote speaker for the event. As well as a sensational lineup of live entertainment from Mel Seargent, Nana Blade DJ and Greg Townley. Guaranteed to be an amazing night, we look forward to seeing you all there!

Barbara Davis - 0402 394 211 berry@zontadistrict24.org



BERRY CWA

Our year was off to an great start with a stall at the Berry Show on February 3 and 4. Thanks must go to the many patrons who purchased handicrafts and chutneys and jams from the stall. We are grateful for your patronage. The money raised will be put to good use assisting those less fortunate in our community. CWA members also assisted the Berry Show Society by making sandwiches on both mornings of the show. Members arrived early, 7.00am, and were busy making hundreds of sandwiches to be sold on the days of the show. CWA is committed to community and this was a wonderful way for members to assist a very worthwhile cause while also meeting new friends from the Show Society.

Our Craft group meets every Wednesday morning at 9.00am in our rooms in Victoria Street. Even if you are not a crafter, everyone is welcome to drop in for a cuppa and find out more about CWA. Book Club and Choir are both up and running for the new year. These groups meet on the third Friday of each month and again, everyone is most welcome to attend. A new initiative from our Cultural Officer, Marie, is a Drama Group. The group is only in the fledgling stage but the response from members has been very enthusiastic and we look forward to possible future productions.....

Please feel free to contact us on any aspect of CWA including membership, craft, choir, book club or the new drama group via our Facebook page (Berry Branch of the CWA of NSW) or email berrycwasecretary@gmail.com.



Jenny Smith, our Branch President, at the Berry Show Stall

Forum launches free landholder resource kit

On 5th February, Berry Landcare held a landholder Forum for the seven year old Berry Bush Links project. Run by Berry Landcare and the NSW National Parks Association, the project was funded, by the NSW Environment Trust. It supports native habitats, biodiversity, and connectivity within the Berry Wildlife Corridor. Thirty three participants heard presentations on wildlife research, conservation land management, and the importance of feral animal control across the Corridor. This was the last forum with David Rush as the project's manager, whose Trust funding has now ended. Berry Landcare congratulate David on an exceptional project achievement and thank him for his dedication and passion.

Ana Gracanin, PhD candidate University of Wollongong (UoW), provided an overview of her local research on arboreal mammals and their use of critical remnant habitats, such as along Beach Road. Her development of 'selfie' camera traps has revealed the otherwise concealed private life of gliders and possums, and their canopy battle with introduced rats.

Ryan Dallas, PhD candidate, UoW, overviewed fox population dynamics, and described changing fox cranium morphologies across the Corridor. Ryan Wall, Shoalhaven Fox Control Project (SFCP), presented an overview of the resources available from this enormously successful community volunteer team, their programs including baiting, shooting and trapping.

Evelyn Osborne, Biosecurity Officer, South East Local Land Services, outlined State Government based resources available to landholders seeking feral animal control and conservation management strategies. Kate Watson, iNaturalist educator, provided a taste of how this easy-to-use web-based application can transform amateur natural world observations into a valuable database for researchers.

The availability of a free downloadable Landholder resources kit was announced at the Forum. It aims to provide information on conservation land management to Berry region landholders. It can be accessed at: <https://landcare.nsw.gov.au/groups/berry-landcare/berry-land-carer-kit/>.

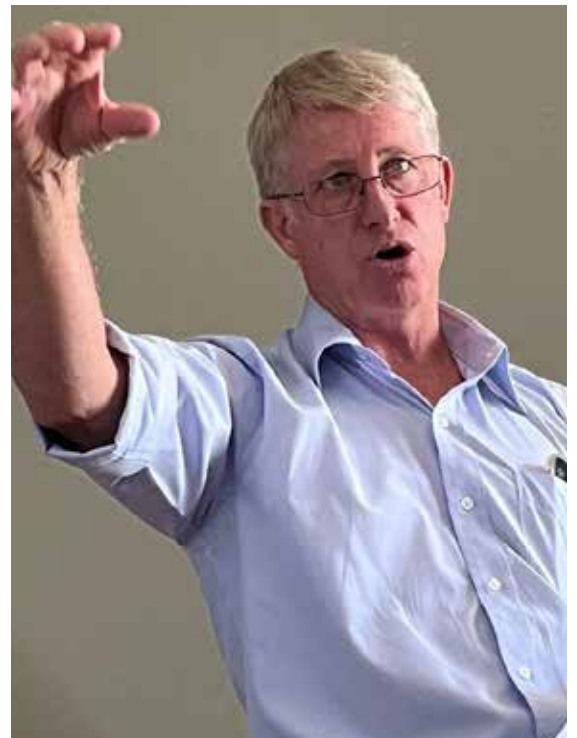

David Rush, on the impact of feral animals.

Shoalhaven Education Fund

On 31 January, the 2023 Shoalhaven Education Fund grants were presented by the Mayor of the Shoalhaven to the successful recipients. A total of \$120,000 in grants was awarded to 46 applicants, which was the highest amount of annual grants given in the SEF's 10 year history. This brings the total amount of grants given since 2012 to over \$650,000.

This year's recipients come from throughout the Shoalhaven, including a number from Berry and surrounds. They will be studying at University and TAFE, in a wide variety of subject areas. Some of the recipients have also received funds from the SEF in past years.

The SEF is hugely grateful to the many community groups, businesses and individuals from Berry and surrounds who have contributed much needed funds and in-kind support to the 2023 grants. We also thank those members of the Berry community who volunteered as interviewers during the 2023 application process.

The SEF committee's work now turns to fundraising for 2024 grants. We will be



holding our regular second hand bookstalls in Broughton Court on the Saturday of each long weekend, so keep an eye out for those. Donations of good quality second hand fiction and children's books can be made at Berry Post Office, Silos Estate cellar door,

or Brian Norwood Accountants in Nowra. We are also always happy to come to talk to local community groups and businesses about what the SEF does. Please contact us at any time at chair@sef.org.au, or see our Facebook page.



A Project of the Berry Uniting Church
BERRY COMPUTERS FOR SENIORS
 P.O. Box 103, Berry, 2535 – Phone: 02-4448-6267
 Email: berrycfs@gmail.com



2023 is our 14th year that we have been able to offer the latest computer technology classes for the people of Berry and the surrounding areas. We are thankful to the Town Crier and residents of Berry for their support. People have joined us from as far afield as Kiama to Falls Creek.

Classes are aimed at helping seniors get more out of their devices. Do not refrain from coming along because you feel you would be out of your depth - our classes are pretty basic and are we here to help no matter what.

Berry Computers for Seniors are pleased to offer the following classes in the use and benefits of:-

iPhones, iPads, Android mobile phones and tablets 9am-10.30am

Windows and Other Microsoft Subjects 11am-12.30pm

Social Morning Tea 10-30am to 11am

Classes continue to be held in the hall of the Berry Uniting Church North Street Entrance (behind the Men's Shed) on the 1st and 3rd Wednesday of the Month (except December /January).

For more information you can call David 0414 982 010 or email berrycfs@gmail.com or just come in for a look.

BERRY RSL SUB-BRANCH AGM 2023



The Berry RSL sub-Branch conducted its AGM on Tuesday 7th February at the sub-Branch Hall.

President Clyde Poulton welcomed Members; the Pledge of Allegiance was read.

In his President's address, Clyde commented on the ANZAC Day march returning to its starting point in the CBD after an absence of 2 years due to Covid, with a special thank you to the Kiama Pipe Band who led the March. Also thanked were a number Berry organisations such as Rotary, Turfco, pupils from Berry Public School for their contribution to a successful Commemoration Service. Similarly, Remembrance Day was well attended.

Of particular note, was the opening in December of the Veterans Wellbeing Centre in Nowra. This facility has been established to help those veterans and their families when in need. The sub-Branch meets on the 1st Tuesday in the month commencing at 9.30 am – we are there to help veterans also

Local historian Robyn Florance has authored two books, "Berry Remember World War II" and "Shoalhaven Memorial Trees". The Berry Remembers Book will be launched shortly and will be advertised in the April edition of the Berry Town Crier.

Significant success was the fundraising efforts especially our monthly function, ANZAC Badge and Poppy Day Appeals to raise money for veterans, current serving ADF members and their families. A big thank to all our volunteers for their efforts.

A special mention to the work of our wonderful ladies of the Women's Auxiliary for their efforts throughout 2022.

Secretary / Treasurer Stuart Christmas covered all aspects of administration, and commented that the sub-Branch was in a sound financial position. Our sub-Branch is reaching into the age of media with the establishment of a Facebook page.

The election of Office-bearers for the next three years was conducted. Elected were:

President: Clyde Poulton.

Vice-Presidents: Ray Strong and Peter Whitton.

Sec / Treasurer: Stuart Christmas.

Welfare: Ray Larder, Ray Strong, and Stuart Christmas

With ANZAC Day in April, any voluntary assistance will be greatly appreciated – again more in next month's Town Crier.

Finally, our sub-Branch can look forward with confidence to 2023 to maintain our traditions along with the sustained support of the Berry community.

DAVID BERRY



HOSPITAL AUXILIARY

NO DECISION HAS YET BEEN MADE BY THE ILLAWARRA SHOALHAVEN LOCAL HEALTH DISTRICT ON THE FUTURE USE OF DAVID BERRY HOSPITAL, WHEN IT RELOCATES TO SHOALHAVEN HOSPITAL IN FOUR YEARS.

Shoalhaven Heads Dance Group held a "Forget-Me-Not" dance in February, and proceeds from the evening went to David Berry Hospital Auxiliary. We thank John and Jan Bailey for their generous donation from a wonderful evening of dancing. These monies will go towards medical items for David Berry Hospital.

Our auxiliary will be hosting the UHA Illawarra Regional Forum on 24th March at the Berry Uniting Church Hall. Covid has prevented a forum for a few years, and this will be an opportunity to hear from our UHA Regional Representative Marjorie Booth, and Luke Worth on behalf of Margot Mains, CEO of Illawarra Shoalhaven Local Health District.

We will hold our annual Easter chicken stall on Wednesday 5th April in Broughton Court and our Mother's Day stall on Saturday 13th May.

Committee members from the Voice of David Berry sub-committee were given a tour of the current Mental Health unit at Shoalhaven Hospital, which will become the new Palliative Care unit when this moves in a few years' time. It requires a complete refurbishment and will provide more beds than currently service Karinya at David Berry Hospital. This committee continues to meet monthly to try to ensure the site eventually remains a health facility.

We meet on the 2nd Monday of the month at 10am in the Uniting Church Hall Berry, but hopefully back at David Berry Hospital when restrictions allow. For any enquiries, please contact Irene Birks on 4464 2612. New members are always welcome.



March gets off to an exciting start with a Cross Country Derby on Sunday 5th March. It is an exciting event combining speed and the calculated skills required to clear challenging solid looking jumps spread over a course, that is close to a kilometre long.

Next up on the calendar is a Working Equitation Ribbon Day, Saturday 18th March. Ribbons will be earned for points scored in the Ease of Handling section. That means riders

are required to negotiate obstacles set out in a specific order. Obstacles might include walking over wooden bridges, manoeuvring around and through tight spaces, sometimes backing in and out of a 20m line of witch's hats. Once riders have mastered courses at the walk the rider can then go up a level and complete the courses at faster paces.

Clear Round Jumping is listed for Sunday 19th March. The day will begin with 70cm and go up from there. Lower jumps will be in the afternoon. Riders will choose their level and ride this preferred height several times, giving their horse confidence to try a higher height in the near future.

Our very popular Matchy Matchy Dressage Competition will complete a busy month of activities at Berry Riding Club. The club will be open for a practice day Saturday 25th March followed by our competition day Sunday 26th March. Competition will be strong with a large field of competitors entered but the most fun part of this comp is riders being able to dress themselves and their horses in the same colour, matchy matchy.

March is also time to start collecting pink accessories because Berry Riding Club's Pink Funkhana is just around the corner Sunday 2nd April. It is really a fun day for all ages and abilities.

Always a lot happening at BRC. Follow us on Facebook to keep up to date.

Check the calendar on our website for upcoming events
www.berryridingclub.com



Raine & Horne® Berry



SOLD

18
Wire
Lane,
Berry



SOLD

454
Strongs
Road,
Jaspers
Brush



SOLD

15
Mount
Vista
Close,
Berry

210A Bong
Bong Road,
Broughton
Vale



18-20
Turley
Avenue,
Bomaderry



19
Bendigo
Circuit,
Nowra



Your Shoalhaven Lifestyle Property Experts



Jacqueline Crapp
0429 104 011

"Having had experience with other local agents in the Berry region over many years, I can without hesitation recommend Jacqui and her team as being the very best by far. Her local market knowledge, straight talking negotiation skills and attention to detail is outstanding. I would have no hesitation in engaging her services for either buying or selling in the future. These are some of the reasons why Raine and Horne Berry is the very much preferred agent by many in the Berry area at this time."



Luke Tancred
0435 283 299

"The whole process from the initial negotiation with Luke was really quite seamless and stress-free, unlike some other agents we dealt with. Luke was very upfront and transparent with all our dealings and is a very personable and professional young man and we wish him well in his career, he is a success already".



Susie Timbs
0414 767 707

"We recently sold our investment property with Susie and cannot recommend her highly enough. Susie was extremely professional, knowledgeable and very considerate when it came to our situation and our tenants. She provided us with an accurate valuation and delivered an amazing result. If you are looking to sell your property, Susie at Raine & Horne Berry won't disappoint. Thank you Susie."

"Kiralee is extraordinary! Always available, always able to find solutions and totally REAL. She understands the market, the process, the emotions and ALL the complexities. She's an absolute marvel and if it hadn't been for her - not only would we not have purchased the property but we'd still be "looking"! Well done and thank you Kiralee - I have no doubt that everyone who has the privilege of working with you will be SO well looked after and SOOO grateful."



Kiralee Whitehead
0418 152 734



Mira Edwards
0414 246 863

"Our sincere thanks for your belief, your professionalism and enormous ability that made it all possible. Thank you for your untiring efforts on our behalf and your incredible negotiating ability - we were so lucky when you strolled into our life."

New contemporary arts festival coming to Berry this June!



An exciting new and immersive contemporary arts festival will be held in Berry from June 22 to 25, 2023, further cementing the town and the Shoalhaven region as a thriving artistic destination. Established to be held every two years, OpenField Arts Festival will showcase contemporary art through out the town in unique non-museum venues, including the School of Arts, several showground buildings and agricultural sites, Berry Courthouse, CWA building and yard, Princess st Reserve, David Berry Memorial Park and the Berry Museum. OpenField Arts Festival is driven by a curatorium of local creatives, volunteers and contracted curators who are developing a stellar program of local and visiting artists across disciplines of sculpture, dance, photography, performance, painting, installation and music. A curated music program of local and visiting musicians and DJs will be presented across two nights as well as a cinema event, workshops, artist talks and panel discussions.

Festival Co-Director and acclaimed Australian

musician Lenka Kripac, a local Berry resident, says "We want to provide a platform to showcase the amazing artistic talent in this area, and also bring high-calibre art from elsewhere, to inspire and invite discourse with locals. There will be performances and events showcasing excellence in music, dance and conceptual art, including immersive sculptural installations for the whole family to enjoy. We will also have a locals art salon and bar at the School of Arts throughout the festival."

The largely-free festival has already confirmed 24 art projects from local and visiting artists, including Tamara Dean, Sophie Cape, Glenn Barkley, James Gulliver Hancock, Claire Healy and Sean Cordeiro, Anna Glynn and Bonnie Porter-Greene.

Celebrated artist and Cambewarra resident Tamara Dean says "To my mind, this region is hungry for artistic engagement, and ripe for a contemporary arts festival. An event in town to bring everyone together to both inspire and challenge the artists, residents and tourists."

Marla Guppy, Chair of South Coast Arts says "We are already seeing wonderful collaborations between artists and community groups. This innovative event will provide a unique platform for communal engagement and connectivity through the arts." OpenField acknowledges that we live and work on stolen land. The festival supports and invites First Nations perspectives and subscribes to truth telling, especially the stories of the traditional custodians of our local

country, the Dhurga and Dharawal speaking people. Throughout the exhibition and program, three local First Nations curators, including Warwick Keen, will collaborate with and support the presentation of work by local and visiting First Nations artists, educators and performers.

Berry Chamber of Commerce President Kate Dezarnaulds says "OpenField will increase and broaden the cultural profile of our town and the NSW South Coast and create a new destination event for our region that showcases our incredible heritage buildings in new ways. It will also provide a much-needed economic boost for the small businesses of our community where the impacts of extreme weather and Covid have really affected the usual rhythm of events that connect and inspire our community."

There is already a groundswell of support for OpenField festival, including founding patrons, sponsors and funding from the Australia Council for the Arts, Shoalhaven

City Council, the Foundation

for Regional and Rural Renewal, Regional Arts NSW and Creative Partnerships Australia.

Photo credited to Ainslie McNamara



For more information visit www.openfield.org.au **Be a part of something special – call for volunteers!**



DAVLIN HEALTH
SHOALHAVEN

Do you feel anxious after the festive season? Is your anxiety impacting your bladder control and causing you to rush to the bathroom or get up frequently at night?

OUR EMSELLA CHAIR CAN HELP YOU. USING ELECTROMAGNETIC ENERGY, THE TREATMENT IS:

- totally non-invasive - you remain fully clothed - no pills, no surgery and no side effects
- proven 95% effective in clinical trials - strengthens the entire pelvic floor

Call Davlin Health in Nowra to arrange your free trial on 0498 111 996
or visit the website www.davlinhealth.com.au or
via the QR code to book in online and view testimonials from happy clients.



**Davlin Health, giving you back your freedom,
self-confidence and dignity - why wait for a better lifestyle?**



Plant Sale Broughton Court March 4th!

Who doesn't love a good plant sale? Our propagation group has a beauty planned Saturday March 4th in Broughton Court from 8:30am - 12:30pm.

Come along to browse a beautiful range of fuscias, hydrangeas, salvias and Little Rubies, to name but a few. Many will be in flower, and our club members will be on hand to provide you with all the advice you need to see them flourishing in your garden. Cash or eftpos.

Our plant propagation group is a much loved part of the Berry Garden Club. The nursery is based at the property of Stan and Lorraine Heath, and it is here that dedicated club members gather on a weekly basis to propagate and tend to the growing plants.

Plants have been selected from many members gardens over the years, and include hard-to-find varieties. Because they are locally sourced, you can be assured they will grow well in this area.

Our main sale for the year is held in October during the Berry Gardens Festival, however you will also find us at the Berry Camellia and Floral Show in August and Small Farm Field Days in September. We also have pop-up sales throughout the year - keep an eye on our social media for details of these.



Proceeds of the plant sales go towards the beautification of Berry.

Past projects including the glorious George Street Park.

So do come along and grab a bargain. And don't forget, as always, we would be delighted to welcome you into our club...you may just be our next budding horticulturist!

 CHECK OUT OUR FACEBOOK PAGE ALSO

Our motto: Friendship through Gardening.

SECRETARY, DEB WOOSTER, WELCOMES ENQUIRIES AT
SECRETARY@BERRYGARDENS.ORG.AU



PLANT PROPAGATION NURSERY

Growing Plants Growing Community

Thank you to the new volunteers. Your contributions are very welcome as life in the nursery is always busy with school and community activities.

Stage 2 students began a 6 week practical program in the nursery in February.

Using magnifying lenses and microscopes, the students observe the function and structure of a variety of leaves and make botanical drawings and pressed herbarium specimens.

Banksia integrifolia, *Banksia serrata* and *Banksia ericifolia* are growing in the school garden allowing the students to identify the physical differences in the leaves, and to appreciate the mature form of the plant.

This herbarium specimen of *Banksia integrifolia* is one of many prepared by Julia, (one of our volunteers). A specimen of this quality shows the students how a plant is preserved for future study.

Illawarra Landcare held a seed propagation workshop in February and **Australian Plants Society Nowra** have scheduled a propagation from cuttings workshop in March..

As well as all this school and community activity, preparations are underway for an upcoming Plant Sale.



AUTUMN PLANT SALE

**25TH MARCH
9.30 - 3.30**



Email Lyn at
berryplantprop@outlook.com
for an updated plant list and
follow the Berry Plant Prop
facebook page for details



Berry Automotive Repairs

**PH: 4464 3999 MB: 0417 251 205
2C Old Creamery Lane, Berry**



Our Services Include:

Rego Inspections, Log Book Compliant New Car Servicing,
Steering and Suspension Repairs, Brake and Clutch
Repairs, Diagnostic Scanning

"When quality & service count, give us a call"

Shoalhaven residents creating real change in fight against illegal dumping

Shoalhaven residents are saying enough is enough when it comes to illegal dumping prompting a sharp upturn in public vigilance and reporting. Council has been asking residents to report illegal dumping of waste, such as used household items, old tyres, green waste or construction waste, by using the NSW Environment Protection Authority (EPA) Report Illegal Dumping (RID) webpage. The state average for public use of the RID website is 11% and Shoalhaven's use of the RID website is 73%. Data from October, November and December 2022 showed that increased reporting directly led to a spike in clean up notices and infringements, with Council's Rangers undertaking three times the amount of enforcement action. James Ruprai, Shoalhaven City Council - Director of City Development said, "Shoalhaven is leading the state with reporting from

residents. This is a significant achievement, and we'd like to thank residents for their help in keeping the Shoalhaven clean." "Greater vigilance and reporting from the community not only sees the prompt removal of waste from our bushland and beaches, but also allows rangers to put preventive measures in place," he said. "The increase in reporting means we have a clearer picture of where, when and what people are dumping illegally and provides greater support for ongoing investigations to find the perpetrators of these illegal acts," said Director Ruprai. Council encourages the community to stay

vigilant and keep reporting by using the EPA Report Illegal Dumping (RID) webpage, with three easy steps - snap a photo, upload it to the RID webpage, and tag your location.



TRADES & SERVICES DIRECTORY

OneStopHomes
YOUR LOCAL BUILDER
NEW HOMES • EXTENSIONS • RENOVATIONS
02 4421 8677 M: 0449 668 439
www.onestophomes.com.au
Life is better in a One Stop Home

Wilson Hirst BUILDING Pty Ltd
YOUR LOCAL BUILDER
NEW HOMES • EXTENSIONS • RENOVATIONS
02 4421 8677 M: 0449 668 439
E: wilsonhirst@hotmail.com

SPACE AVAILABLE
Contact the Editor 0428 037 572
towncrier@berryalliance.org.au

wholebody PHYSIOTHERAPY
...dedicated to your wellbeing
Mary Pentecost
84 Queen Street Berry NSW 2535
email: wbpqueen84@hotmail.com
4464 2874

SUPPORT LOCAL BUSINESSES

John Hawkins Concretor
We aim for a professional finish and work with the customer to obtain the job they desire.
Specialising in:
• Stamped
• Stencil
• Colour Cove
• Black Basalt
• Machine Finish
• Stained
P: 0401 236 850
FULLY LICENSED & INSURED • QUALITY FIRST • LIC NO: 169901c

THE BOUTIQUE GYM
Personal Trainer Jen Miller
117 North Street,
Berry NSW 2535
0413 648 943
jenmiller65@hotmail.com

BERRY REMOVALS
LOCAL • COUNTRY • INTERSTATE
Experience a New Level of Professionalism
Phone 04 2864 3557 or 4464 3557

our Legged riends Pet Feeding Service
FOR ALL DOMESTIC PETS AND FARM ANIMALS
• FEEDING • EXERCISING • RUGGING
• GARDEN / MAIL / GARBAGE
Megan White 0407 407 328
Dip in Animal Care
ESTABLISHED 1995
www.fourleggedfriends.com.au

TRADES & SERVICES DIRECTORY

Vaughn's Lawn & Garden Service



- Local knowledge
- Professional service
- Fully insured

0408 863 776

www.vaughnsgardening.com.au

G.M. Ellison & Co. lawyers • conveyancers

Graham Ellison LL.B.

- Real Estate & Business Conveyancing
- Wills, Probate and Personal Arrangements

5 HOST PLACE BERRY

Ph: 0408 444 808

graham@gmellisonlawyers.com.au



For all your concreting & Landscaping projects
Call or text Ben on 0438 703 109



PCA
ANTHONY LEWIS
BDC 0228

PCA
JARED NEVILL
BDC 2523

02 4421 0004 info@aiscertifiers.com.au

SHOALHAVEN ANTENNAS

DIGITAL ANTENNA SPECIALIST



Servicing Berry and Surrounding Areas

- Digital Upgrades • New Installs • TV Tuning
- Repair Existing Systems • Add Phone/TV Outlets

shoalhavenantennas@gmail.com

Ph: 0410 526 672 Fax: 02 4422 6672

your
build
yourbuild.com.au

extensions / renovations
new home builds / commercial fitouts

Simon Tabet 0400 752 385

ABN: 32 637 043 871 LIC: 346203c



- Solar quote, design, install, repair and maintenance
- Mains electrical connection
- Underground sub mains to building or structure
- Oven, cooktop and rangehood repair or installation
- Meter box upgrade with safety switched or three phase supply

- New house wire or remodeling
- Hot water install
- Outdoor lighting
- Fan install
- All your electrical needs

**GREG KELLY
LOCAL ELECTRICIAN**

0487 093 173

Licence Number 270316C



**MICHAEL HILL
PAINTER & DECORATOR**
Quality Work Guaranteed

Domestic Commercial Industrial

ABN 95 969 204 488 Lic No 121389C

0402474569

- Specialising In
- New/Old work
 - Feature Walls
 - Roofs
 - Texture Coating
 - Heritage



**All Creatures
Mobile Vet**

- Convenient pet health checks and vaccinations
- Compassionate euthanasia at home
- Complete range of Veterinary services
- Pick up and drop off service when your pet needs to visit our hospital
- No call out fee
- Emergency service available
- Service area from Albion Park to Milton NSW

Personalised Veterinary care at home

(02) 4464 1899 www.allcreaturesmobilevet.com.au

PLUMBER DRAINER GASFITTER MINI EXCAVATION

**Marland
Plumbing Services**



Licence No. 72832C
ABN 43 571 877 557

Over 25 Years Experience in the Shoalhaven

Phone: 4480 2251 Mobile: 0412 044 135
marlandplumbing@iinet.net.au

**ELECTRICAL
CONTRACTOR**

EEPS
Lic. No. 133674C

DOMESTIC & COMMERCIAL

- Solar Power Installation
- Home Automation Systems
- Security Lighting
- Pools & Spas
- Hot Water Systems
- Oven & Stove Repairs
- Safety Switches
- Smoke Detectors

Contact peter today!

0412 594 907 | 4464 1993

ENDEAVOUR ENERGY AUTHORISED LEVEL 2 SERVICE PROVIDER



**RBS
rural bitumen services pty ltd**

Specializing in Private Road Construction
& Bitumen Seal

- Driveways
- Carparks
- Decorative driveways
- Fully Insured

Contact Office (02) 4464 1555

James 0416 269 744

MOTATEC
EXPERIENCE - EXCELLENCE

AUTOMOTIVE SERVICE CENTRE

SERVICING | REPAIRS | PINK & BLUE SLIPS
FOR ALL MAKES & MODELS

EUROPEAN SPECIALISTS
COURTESY CAR AVAILABLE

96 NORTH ST, NOWRA

CALL 4424 0803



SPACE AVAILABLE

Contact the Editor 0428 037 572
towncrier@berryalliance.org.au

MANN MADE
BUILDING & CONSTRUCTION

CHRIS MANN 0431 671 475

mmbuildingandconstruction@gmail.com

NEW HOMES | RENOVATIONS | EXTENSIONS | DECKS-PERGOLAS | CONCRETING

ABN 40 624 149 506 LIC. NO. 292587C

TRADES & SERVICES DIRECTORY



Automotive Residential
Commercial Industrial

MOBILE 24/7 LOCKSMITH SERVICE
0498 770 088

www.jetlocksmiths.com.au
Master Locksmith | Security Lic #000101098

MECHANICS TO YOU!



MOBILE SERVICE & REPAIRS
LAWN MOWERS | TRACTORS | TRUCKS | FARM EQUIPMENT

CALL 0414 800 359

**NATURAL AREAS
MANAGEMENT AND
WEED CONTROL**



Full Environmental Restoration Services

Garden Install and Maintenance

Revegetation Services

Expert Advice and Support

Jeff Harbrow
Qualified Bush
Regenerator &
Native Plant Specialist
0428 292 999
adri@whipbirdenvironmental.com.au

Large scale landscaping experts

- Experienced weed control specialists
- Qualified in Conservation and Land Management
- Waterway, dam and landscape revegetation
- Based locally in Berry
- Call to discuss the needs for your property

Contact:
ashley.spain@ecodynamics.com.au
0429 933 077

ecodynamics.com.au



ROB PACKER POND & DAM CARE

- Algae & weed control
- Pumps & filtration
- Fish & plants
- Maintenance & repairs

0409 550 741



PLUMBING + ELECTRICAL

1300 792 082

www.callcurran.com.au

Family owned & operated business since 1990

Bush Regeneration & Feral Management



WE CAN WORK IN AREAS TOO STEEP FOR MACHINERY

Weed Control

- Lantana & privet clearing
- Tree felling & log chainsawing
- Fire trail construction
- High volume spraying
- Rainforest replanting

Professional Shooting

- Professional firearms licences
- Silencer permits
- Firearms Safety Assessor & Hunting Educator
- Comprehensive risk assessments



COMPLETE ENVIRONMENTAL RESTORATION SINCE 2016

Len White 0406 412 911 info@lonefig.com.au www.lonefig.com.au

JOBS SMALL AND LARGE



Ferncroft Rural & Landscaping Pty Ltd

- Excavator Hire (5T & 2T) | Tipper Hire
- Tractor Hire (fence post driving, slashing, front end loader, weed spraying)

PLEASE CALL 0418 205 225



All Jobs Carpentry

Decks, Pergolas, Maintenance,
Renovations, Additions,
Kitchen & Bathroom Reno's

Free Quotes 0434392017 LIC NO: 317866C



KANGAROO VALLEY

CALL BILL OR DEBBIE
0424 867 994 / 0401 759 241

info@surfelectrical.com.au

Like us on Facebook!

Review us on Google ★★★★★

AREAS OF SERVICE:

BERRY / KANGAROO VALLEY / CAMBEWARRA /
GERRINGONG / SOUTHERN HIGHLANDS

- Fully Insured • 20+ years experience
- Residential • Commercial • Industrial
- New Homes • Renovations & Extensions
- Maintenance • Repairs • Upgrades • Installations

ABN 70 845 107 241 LIC No. 253095C



FOCUSED Cleans

focusedcleans.com.au

We focus on...

- Homes
- Offices
- End of lease cleans
- Holiday home cleans
- Insurance cleans
- Spring cleans
- Windows
- Ovens



P 02 4423 4521 M 0431 774 774



MISS SPARKLES

SHOALHAVEN

External House Cleaning

HOUSES FROM \$148

- ★ Environmentally Friendly
- ★ House/Driveway Packages
- ★ Removal of Cobwebs
- ★ Patios and Driveways
- ★ Mildew Treatment
- ★ Windows/Screens included
- ★ Commercial work
- ★ Seniors Discount

Phone Dennis for a free quote:
0407 642 256

Now Offering: Internal Window Cleaning &
Licensed/Insured Electrical Work (Lic No. 209514C)



physiotherapy
pelvic health
pilates
massage

4234 4666

Book online: gerringongphysio.com



Southern Tree Service

- Qualified Arborist
- Qualified Horticulturist
- Tree care and maintenance
- Expert trimming and tree removal in confined areas
- Chipper • Mulch
- Advice on replacements
- Stump Grinding
- Fully Insured

Paul Gillen

Ph/Fax 4464 2822 • Mobile 0407 405 968

Ian's Interior Linings



★ All plasterboard & fibrous plastering

★ Commercial & Domestic

M: 0418 220 751

E: willey63@bigpond.com.au

Welcoming Rhiannan Harvey to the team

Assistant to Tim McGoldrick



Galvanising her passion for property and the stories they hold, Rhiannan's journey in the industry began straight out of high school, allowing her to explore and list some of the South Coast's finest homes, now working alongside Tim McGoldrick as a Sales Assistant.

Nothing is ever a drama for Rhiannan – tackling all tasks, big and small, with confidence and effervescent energy. Fastidious and dependable, she is always there to answer questions and hold your hand throughout the process of buying and selling. Lighting up McGoldrick's office, Rhiannan's loyalty and dedication impress warmth and a family spirit to her relationships, expanding to clients' families and friends, who in turn, seek her professional service.

Surrounded by her family and indulging in Berry's relaxed lifestyle out of the office, Rhiannan loves getting away for a weekend of golf, enjoying the fabulous shops and cafes in the area, and sharing a cheese platter and paired wine with good company.

If you'd like to get a better understanding of your property in the current market place, make sure you contact the team at McGoldrick Estate Agents to have a confidential discuss about your plans.

Specialising in:

- Residential
- Lifestyle
- Rural

